

# Annie #110

Designed, made & painted by Niomi Draper

## Deco Art Americana Paint

Deep Midnight Blue Uniform Blue Mocha  
Heritage Brick Asphaltum Eggshell  
Black Green

## Other Paints/Varnishes

- Jo Sonja's -  
Soft White, Black  
Gloss Varnish

## Supplier's 'N' Needful Things

- A Hardware Store -  
3mm mdg  
Light Grade Sandpaper  
Scraps of fabric

[www.farmhousecollectables.au.com](http://www.farmhousecollectables.au.com)

Copyright 2002- 2010. All Rights Reserved.

# Annie



Designed, made & painted

by Niomi Draper

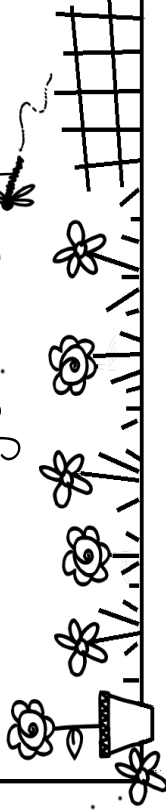
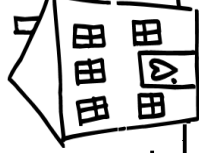

# Annie #110

Pattern Designed and Painted By Niomi Draper.

## Preparation.

Use a sharp pencil and tracing paper, trace over the entire pattern! On to 3mm MDF trace square, Use a scroll saw to cut out the shape. Go slow, cut out the cow neatly. Sand the edges. Ensure the surface is clean, dry and free of markings. Drill the holes at the top. Basecoat the square in \*Soft White and trace on the pattern.

## Painting Instructions.

### Bow.

Paint the bow in \*Uniform Blue. Shade the lower section of the bow and the ties with \*Deep Midnight Blue. Highlight the tops of the bow, the top and outer edge of the ties in \*Soft white. Dot the dots with \*Soft White.

### Face and Neck.

Basecoat the face and neck with \*Mocha. Trace off some more details. Shade around the face under the bow and the chin with \*Asphaltum. Dry brush the cheeks using \*Heritage Brick also paint the nose stitching. Paint over the nose stitching again with \*Soft White. Dot the eyes \*Black, paint the eyelashes and mouth - - - - .

### Collar.

Basecoat the collar with \*Eggshell. Shade around the collar with \*Black Green. Paint the checked lines once with \*Black Green and again with \*Soft White.

## Finishing Touches.

Paint around the pattern with \*Black. Paint the collar bow. Dot the bow in the centre with \*Soft White. Dot the eyes too. Shade around the design with \*Bittersweet Chocolate. Trace off the hair. Paint the hair with \*Heritage Brick. Vanish with Glass Vanish.



#110 Annie  
Copyright Niomi Draper